

HOT STICKS & TOOLS



HOT STICKS & TOOLS

FAQ

Q: Are rescue sticks required to be periodically electrically tested?

A: Yes, see OSHA 1910.269(j) for specific testing requirements.

NOTE

Don't see what you need here? Salisbury has an additional extended line of grounding equipment, hot sticks and tools available. Ask your local Salisbury by Honeywell representative for more information or visit whsalisbury.com for an online version of the full catalog of products.



FIBERGLASS HOT STICKS

STANDARD SPECIFICATIONS

There are a variety of Fiberglass Reinforced Plastic (FRP) constructions used for hot sticks. Included are foam filled tubular sticks used for all products requiring solid construction. All Salisbury fiberglass sticks meet ASTM F711 Standard Specifications for FRP and tube used in live line tools and IEC 855.

Foam filled hot sticks are manufactured using the pultrusion process. This method incorporate fiberglass reinforcement in a resin matrix which creates a moisture resistant laminate with excellent electrical and mechanical properties.

Hot stick production is 100% electrically proof tested. Hot Stick blanks must conform with ASTM F711 requirements.



Live Line Work Minimum Approach Distance		
Nominal Voltage kV	Exposure Distance ft-in (m)	
	Phase to Ground	Phase to Phase
.05 to 1	avoid contact	avoid contact
1.1 to 15	2-1 (.64)	2-2 (.66)
15.1 to 36	2-4 (.72)	2-7 (.77)
36.1 to 46	2-7 (.77)	2-10 (.85)
46.1 to 72.5	3-0 (.9)	3-6 (1.05)
72.6 to 121	3-2 (.95)	4-3 (1.29)
138 to 145	3-7 (1.09)	4-11 (1.5)
161 to 169	4-0 (1.22)	5-8 (1.71)
230 to 242	5-3 (1.59)	7-6 (2.27)
345 to 362	8-6 (2.59)	12.6 (3.8)
500 to 550	11-3 (3.42)	18-1 (5.5)
765 to 800	14-11 (4.53)	26-0 (7.91)

- These distances take into consideration the highest switch surge an employee will be exposed to on any system with air as the insulating medium and the maximum voltage shown.

-The clear live-line total distances shall equal or exceed the values for the indicated voltage ranges.

FRP CLAMPSTICKS

Tough Thermoplastic head ferrule.
EZ Grip plastic hand grip.
Wide opening 15/16" (23.8mm)
stainless steel hook.
Heavy duty rubber end cap.

External Rod Clampsticks are constructed of closed cell foam-filled tubular fiberglass in accordance with ASTM standard F711. The hook's operating rod, made of solid 3/8" (9.5mm) dia. fiberglass, is mounted on the exterior of the tool so that it can be easily wiped down prior to use.

These Clampsticks meet ASTM F1825 Standards.

Cat. No.	Length		Weight ea.	
	Feet	Meters	lbs.	kgs
EXTERNAL ROD CLAMPSTICK				
4007	4' 8"	1.32	4.2	1.9
4008	5' 8"	1.62	4.6	2.1
4009	6' 8"	1.93	5.2	2.4
4010	8' 8"	2.54	6.2	2.8
4011	10' 8"	3.15	7.0	3.2
4012	12' 8"	3.76	7.7	3.5
4013	14' 8"	4.37	9.4	4.3

Add a "9864" suffix for a Switch Stick Head or a "9840" suffix for a Splined Universal Head. Clamp sticks may be ordered with these fittings attached to the end by adding the appropriate suffix to the catalog number.



Side Opening Hook



9840 Splined Universal Head



External Rod Clampstick

UNIVERSAL SWITCH STICKS

One, two, and three section hot sticks have a standard splined universal head. 1.25" dia. switch sticks are supplied with a #9971 Prong. A Heavy Duty Disconnect Prong #9969 is supplied on all others.



9969 Prong



9971 Prong

Cat. No.	Dimensions: Dia. x Length		Weight ea.					
	in x ft.	mm x m	lbs.	kgs				
ONE SECTION								
4213	1.25 x 4	31.7 x 1.2	2.6	1.2				
4214	1.25 x 6	31.7 x 1.8	3.4	1.5				
4215	1.25 x 8	31.7 x 2.4	4.1	1.9				
4216	1.25 x 10	31.7 x 3	4.9	2.2				
4217	1.25 x 12	31.7 x 3.6	5.6	2.5				
4218	1.25 x 14	31.7 x 4.3	6.4	2.9				
4219	1.5 x 8	38.1 x 2.4	5.4	2.5				
4220	1.5 x 10	38.1 x 3	6.5	3				
4221	1.5 x 12	38.1 x 3.6	7.5	3.4				
4222	1.5 x 14	38.1 x 4.3	8.6	3.9				
4223	1.5 x 16	38.1 x 4.9	9.8	4.3				
4225	1.5 x 20	38.1 x 6	11.7	5.3				
TWO SECTIONS								
	OAL Length		Top		Bottom		lbs.	kgs
	ft.	m	in. x ft.	mm x m	in. x ft.	mm x m		
4036	8	2.4	1.25 x 4	31.7 x 1.2	1.25 x 4	31.7 x 1.2	4.2	1.9
4037	10	3	1.25 x 5	31.7 x 1.5	1.25 x 5	31.7 x 1.5	5.2	2.2
4038	12	3.6	1.25 x 6	31.7 x 1.8	1.5 x 6	38.1 x 1.8	6.9	3.1
4039	14	4.3	1.25 x 6	31.7 x 1.8	1.5 x 8	38.1 x 2.4	7.9	3.1
4040	16	4.9	1.25 x 8	31.7 x 2.4	1.5 x 8	38.1 x 2.4	8.6	3.9
4041	18	5.5	1.25 x 8	31.7 x 2.4	1.5 x 10	38.1 x 3	9.6	4.4
4042	20	6	1.25 x 10	31.7 x 3	1.5 x 10	38.1 x 3	10.4	4.7
THREE SECTION								
	OAL Length		Top		Middle / Bottom		lbs.	kgs
	ft.	m	in x ft.	mm x m	in. x ft.	mm x m		
4043	12	3.6	1.25 x 4	31.7 x 1.2	1.5 x 4	38.1 x 1.2	7.7	3.5
4044	15	4.6	1.25 x 5	31.7 x 1.5	1.5 x 5	38.1 x 1.5	9.1	4.1
4045	18	5.5	1.25 x 6	31.7 x 1.8	1.5 x 6	38.1 x 1.8	10.5	4.7
4046	20	6	1.25 x 8	31.7 x 2.4	1.5 x 6	38.1 x 1.8	16.5	7.5
HEAD ONLY								
9840			1.25	31.7	Universal Head		0.2	0.1
9841			1.5	38.1	Universal Head		0.3	0.1



Universal Switch Stick



FRP Splices with Button

FIBERGLASS HOT SWITCH STICKS

Switch Sticks use closed cell foam filled tubular fiberglass made in accordance with ASTM Standard F711. Both the standard head and the heavy duty prong disconnect are made of durable high strength aluminum bronze alloy.



Standard Prong



Heavy Duty Prong



Fiberglass Hot Switch Stick

Cat. No. HD	Std	Prong	Dimensions: Dia. x Length				Weight ea.		
			in. x ft.		mm x m		lbs.	kgs	
ONE SECTION									
9950	9933		1.25 x 4		31.7 x 1.2		2.1	1	
9951	9934		1.25 x 6		31.7 x 1.8		2.9	1.3	
9952	9935		1.25 x 8		31.7 x 2.4		3.6	1.6	
9953	9936		1.25 x 10		31.7 x 3		4.4	2	
9954	9937		1.25 x 12		31.7 x 3.6		5.1	2.3	
9955	9938		1.25 x 14		31.7 x 4.3		5.9	2.7	
9956	9939		1.5 x 8		38.1 x 2.4		5	2.3	
9957	9940		1.5 x 10		38.1 x 3		6	2.7	
9958	9941		1.5 x 12		38.1 x 3.6		7	3.2	
9959	9942		1.5 x 14		38.1 x 4.3		8.1	3.7	
9960	9943		1.5 x 16		38.1 x 4.9		9.1	4.1	
9961	9944		1.5 x 18		38.1 x 5.5		10.2	4.6	
9962	9945		1.5 x 20		38.1 x 6		11.2	5.1	
TWO SECTION									
			OAL Length		Top		Bottom		
			ft.	m	in. x ft.	mm x m	in. x ft.	mm x m	lbs. kgs
4024	-		8	2.4	1.25 x 4	31.7 x 1.2	1.25 x 4	31.7 x 1.2	3.8 1.7
4025	-		10	3	1.25 x 5	31.7 x 1.5	1.25 x 5	31.7 x 1.5	4.6 2.1
4026	4016		12	3.6	1.25 x 6	31.7 x 1.8	1.25 x 6	31.7 x 1.8	5.3 2.4
-	4017		14	4.3	1.25 x 7	31.7 x 2.1	1.25 x 7	31.7 x 2.1	6.1 2.7
4028	4018		16	4.9	1.25 x 8	31.7 x 2.4	1.5 x 8	38.1 x 2.4	8 3.6
4029	-		18	5.5	1.25 x 8	31.7 x 2.4	1.5 x 10	38.1 x 3	9.5 4.3
4030	-		20	6	1.25 x 10	31.7 x 3	1.5 x 10	38.1 x 3	10.3 4.6
THREE SECTION									
			OAL Length		Top		Middle / Bottom		
			in.	mm	in. x ft.	mm x m	in. x ft.	mm x m	lbs. kgs
4033	-		18	5.5	1.25 x 6	31.7 x 1.8	1.5 x 6	38.1 x 1.8	10.4 4.7
4034	4035		20	2	1.25 x 8	31.7 x 2.4	1.5 x 6	38.1 x 1.8	11.1 5
HEAD ONLY									
-	9864				1.25	31.7	Universal Head		0.4 0.2
9861	-				1.5	38.1	Universal Head		0.5 0.2

UNIVERSAL SWITCH STICKS & ACCESSORIES

DOUBLE ENDED & TIE HEADS



4182 Cap
Splice Guard

FRP Sleeve Splices are fiberglass reinforced plastic with spring loaded push buttons. They sectionize long sticks for easy storage. For splice stick assemblies other than those listed in the catalog consult the factory for quotations.

Splice Guards reduce the damage to the end of spliced sticks when working with only the top sections.



FRP Splices with Button

Cat. No.	Dimensions		Weight ea.	
	in.	mm	lbs.	kgs
FRP SLEEVE SPLICES				
9898	1.25 to 1.25	31.7 to 31.7	0.4	0.2
9897	1.5 to 1.25	38.1 to 31.7	0.8	0.4
9899	1.5 to 1.5	38.1 to 38.1	0.9	0.4
SPLICE GUARD CAP				
4182	1.25 I.D.	31.7 I.D.	0.2	0.1

These foam filled FRP Hot Sticks are manufactured using a pultrusion process that results in a product with extremely high electrical and mechanical qualities.



4084 Rotary Prong



4088 Double Prong Head

Cat. No.		Dimensions: Dia. x Length		Weight ea.	
		in. x ft.	mm x m	lbs.	kgs
DOUBLE ENDED UNIVERSAL					
4230		1.25 x 6	31.7 x 1.8	3.3	1.5
4231		1.25 x 8	31.7 x 2.4	4	1.8
4232		1.25 x 10	31.7 x 3	4.8	2.2
4233		1.25 x 12	31.7 x 3.6	5.5	2.5
4234		1.25 x 14	31.7 x 4.3	6.3	2.8
UNIVERSAL w/ Rotary Prong or Blade					
4084	Rotary Prong	1.25 x 6	31.7 x 1.8	3.8	1.7
4085	Rotary Prong	1.25 x 8	31.7 x 2.4	4.5	2
UNIVERSAL w/ Double Prong					
4088		1.25 x 6	31.7 x 1.8	3.8	1.7
4089		1.25 x 8	31.7 x 2.4	4.5	2



Double Ended Universal
Switch Stick

RESCUE HOOK, STATIC DISCHARGE STICK

Salisbury Insulated Rescue Hook is an invaluable tool for any workplace used to withdraw an injured worker out of a hazardous area. Confined spaces, in vaults, or just near electrical cabinets and switch gear are some of the places where this tool is a must. Featuring a foam filled, fiberglass reinforced handle for superior electrical insulation and a coated heat treated body hook with an 18" opening. The stick is available in the standard lengths of 6 and 8-foot lengths. Other lengths are available as a special order. Contact us with your requirements. Handle meets the requirements of ASTM F711.



Insulated Rescue Hook

The Static Discharge Stick is designed to safely remove the static charge after de-energizing. This tool is pre-assembled and includes a copper "U" hook, 3'6" closed cell foam filled tubular fiberglass stick and 6' of copper grounding cable attached to a Salisbury 1814 bronze flat jaw serrated grade 3 clamp. Also available in a 1' length stick.

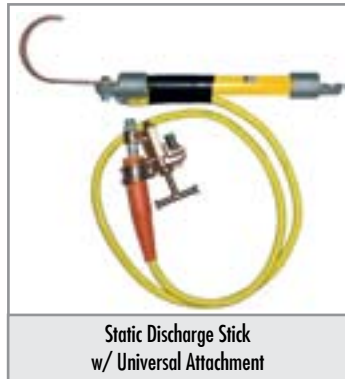

Static Discharge Stick
w/ Universal Attachment



Static Discharge Stick



WARNING:

Discharge sticks are not grounding tools as described by OSHA 1910.269 and carry no fault duty rating.

Cat. No.	Dimensions		Weight ea.	
	in.	mm	lbs.	kgs
INSULATED RESCUE HOOK				
24400	Rescue Hook 3' (0.9 m) length		3.4	(1.5)
24401	Rescue Hook 6' (1.8 m) length		4.5	(2)
24403	Rescue Hook 8' (2.4 m) length		5.5	(2.5)
STATIC DISCHARGE STICK				
20817	Static Discharge Stick OAL 3'8" (1.08m) length		8	(3.6)
22629	Static Discharge Stick w/ Universal Attachment 1' (0.3m) length		.38	(0.17)

STORAGE FOR HOT STICKS & TOOLS



SALCOR® Tool Holders secure tools to trailers, compartments and tool rooms. 12 per package.

Cat. No.	Description	lbs. (kgs)
1192	1.25 (32mm) I.D. Tool Holder	3.5 (1.6)

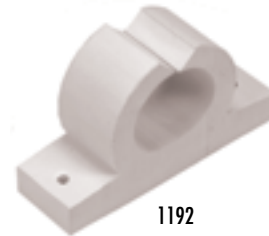

1192

Tubular PVC Storage Containers provide weather tight storage. Kit includes two mounting brackets and four steel bolts with each 6" (152mm) I.D. or 4.1" (104mm) tube. Sized for tools 12" (305mm) shorter than tube. Four mounting bolts 3/8" x 1.5" (9.5 x 38mm) are supplied with each container.

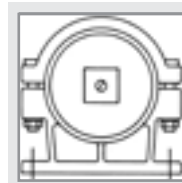

5.75" (146mm) or 8" (203mm) width



4155

Kit may be ordered without tubing, or with mounting rackets only.

Cat. No.	Description/Dimensions in. (mm)	lbs. (kgs)
9822	Kit for 6" (152) I.D. 6.6" (168) O.D. tube	8 (3.5)
9823	Kit for 4.1" (104) I.D. 4.5" (114) O.D. tube	6 (2.7)

Cat. No.	Length Feet	Length meters	Weight ea. lbs. (kgs)
----------	----------------	------------------	----------------------------

HOT STICK BAGS

4297	5	1.5	.7 (.3)
4298	6	1.8	.8 (.3)
4299	6' 4"	1.9	.9 (.4)
4300	7	2	1 (.4)
4301	8' 4"	2.5	1.1 (.5)
4302	9	2.7	1.2 (.5)
4303	10' 4"	3	1.4 (.6)

4" I.D. TUBULAR PVC STORAGE KIT

4155	7	2.13	17 (7.7)
4156	9	2.74	20 (9)

6" I.D. TUBULAR PVC STORAGE KIT

4167	6	1.82	20 (9)
4168	7	2.13	22 (10)
4169	9	2.74	26 (11.7)

Hot Stick Bags are constructed of heavy vinyl with double stitched seams. Flaps snap closed. 6" (152mm) wide and designed to hold sticks up to 4" (102mm) shorter than bag length shown on chart.



Hot Stick

UNIVERSAL FITTINGS

Universal Fittings, constructed of bronze or aluminum, can be installed on universal sticks or clamp sticks by using the 2500 shotgun adaptor.



2500 Shotgun Adaptor

.4 lbs (.2 kgs)



4236 Tree / Wire Hook

.36 lbs (.2kgs)



9878 Pig Tail Disconnect

.4 lbs (.2 kgs)



9838 Chuck Blank

Inside Depth: 1/2" x 1 1/2" (13 x 38mm)
.4 lbs (.2 kgs)



9971 Light Duty Cutout Prong

.4 lbs (.2 kgs)



9969 Heavy Duty Disconnect Head

.6 lbs (.3 kgs)



9970 Prong Disconnect

.4 lbs (.2 kgs)



4099 Rotary Prong Tie Head

.6 lbs (.27 kgs)



4100 Rotary Blade Tie Head

.7 lbs (.3 kgs)



9839 Pointed Disconnect

.4 lbs (.2 kgs)



4101 Double Prong Tie Head

.5 lbs (.22 kgs)



4102 Fixed Blade Tie Head

.5 lbs (.22 kgs)

UNIVERSAL FITTINGS



4108 Tubular Line Cleaner 1.3 lbs (.6 kgs)
4109 Replacement Brush .5 lbs (.22 kgs)



4111 "V" Line Cleaner 1.3 lbs (.6 kgs)
4113 Replacement Brushes
Carton of ten 3 lbs (1.4 kgs)



4106 Curved Blade Skinning Knife .4 lbs (.2 kgs)
4107 Replacement Blade .1 lbs (.05 kgs)



4103 Handle for pruning saw .5 lbs (.22 kgs)



4104 Pruning Saw w/ 18''(457mm) blade .5 lbs (.22 kgs)



9834 Clamp Stick Head 1.4 lbs (.6 kgs)

4105 Tree Pruner
Mounted on 12' (3.6m) fiberglass pole,
complete with 25' (7.62m) of line
.4 lbs (.2 kgs)



UST Universal System Tool
Blanket Pin 1 lb. (.45 kgs)



4114 Flex Head Socket Wrench 1.2 lbs (.5 kgs)



4115 Ratchet Wrench
1/2" (12.7 mm) sq. drive
.5 lbs (.22 kgs)

HYDRAULIC CABLE SPIKE

The **Hydraulic Cable Spike** is designed to verify underground cable, up to 1000MCM, is de-energized before cutting, repairing, splicing or replacing.

The cable spike, a solid brass body with a stainless steel piercing tip, is fitted to hydraulic compression tools so that the cable can be accurately spiked from a safe distance. An anodized aluminum insert is included to position the cable precisely.



24320



WARNING: ELECTRIC SHOCK HAZARD

This tool is not insulated. Use only certified, non-conductive hoses, dielectric fluids, and proper personal protective equipment when using this unit. Failure to do so could result in severe injury or death.

**Improves Control,
Accuracy and Safety
Saves Time
Remote Controlled**

Adapter fits the following tools:

- Huskie EP610H
- Burndy Y46
- Brock 13-H

Cat. No.	Cable Length ft (m)	Description	Weight ea. lbs. (kgs)
24320	6 (1.8)	Spiking Tool & Grounding Assembly:	9.5 (4.3)
		Cable Spiking Tool & Insert	
24321	8 (2.4)	4388 C Clamp	11.2 (5.1)
		2139 4/0 Cu Cable	
24322	10 (3)	2025 4/0 Cu Ferrules (Pair)	12.9 (5.86)
		616 Bag	
		US Patent # 544 7450	
RPT1		Replacement Piercing Tip	1 oz (28 g)

FIBERGLASS HOT CLAMPSTICKS REPAIR PARTS LIST

EXTERNAL ROD

Ref. No.	Cat. No.	Description
1	20178	Guide Assembly
2	20260	Roll Pin .125" Dia. x .5" Lg. (3.2 x 13mm)
3	20174	Ferrule
4*	20265-1	Operating Rod
5*	20381	Operating Rod Guide
6	20250	Handguard Sleeve
7	20114	Hot Stick Blank 1.25" Dia. (32mm)
8	20262	Roll Pin .125 Dia. x .56 Lg. (3.2 x 14mm)
9	20251	Operating Rod Connector
10	20258	Hex Socket Set Screw .375-16 x 1.25
11	20257	Flat Head Screw 10-32 x 1.125 Lg. (254-813 x 29)
12	20253	Adjustment Block
13	20254	Compression Spring
14	20139	Button
15	20263	Roll Pin .125 Dia. x .75 Lg. (3.2 x 19)
16	20445	10-32 Hex Jam Nut
17	20443	Hex Head Machine Screw 10-32 x 1.25
18	20140	Trigger
19	20255	Torsion Spring
20	20141	Handgrip
21	20142	Rack for Handgrip
22	20257	Flat Head Screw 10-32 x 1.125 Lg. (254-813 x 29)
23	20252	Handgrip Sleeve
24	1959	End Cap
25	20176	Jaw Hook
26	20332	Roll Pin .25 Dia. x .47 Lg. (6 x 12)
27	20470	Hook Spring
28	20177	Hook Holder

Assembly No.	Description	Consist of Parts
4317	Hook Assembly	28, 29, 30, 31

